

MECANIZADO

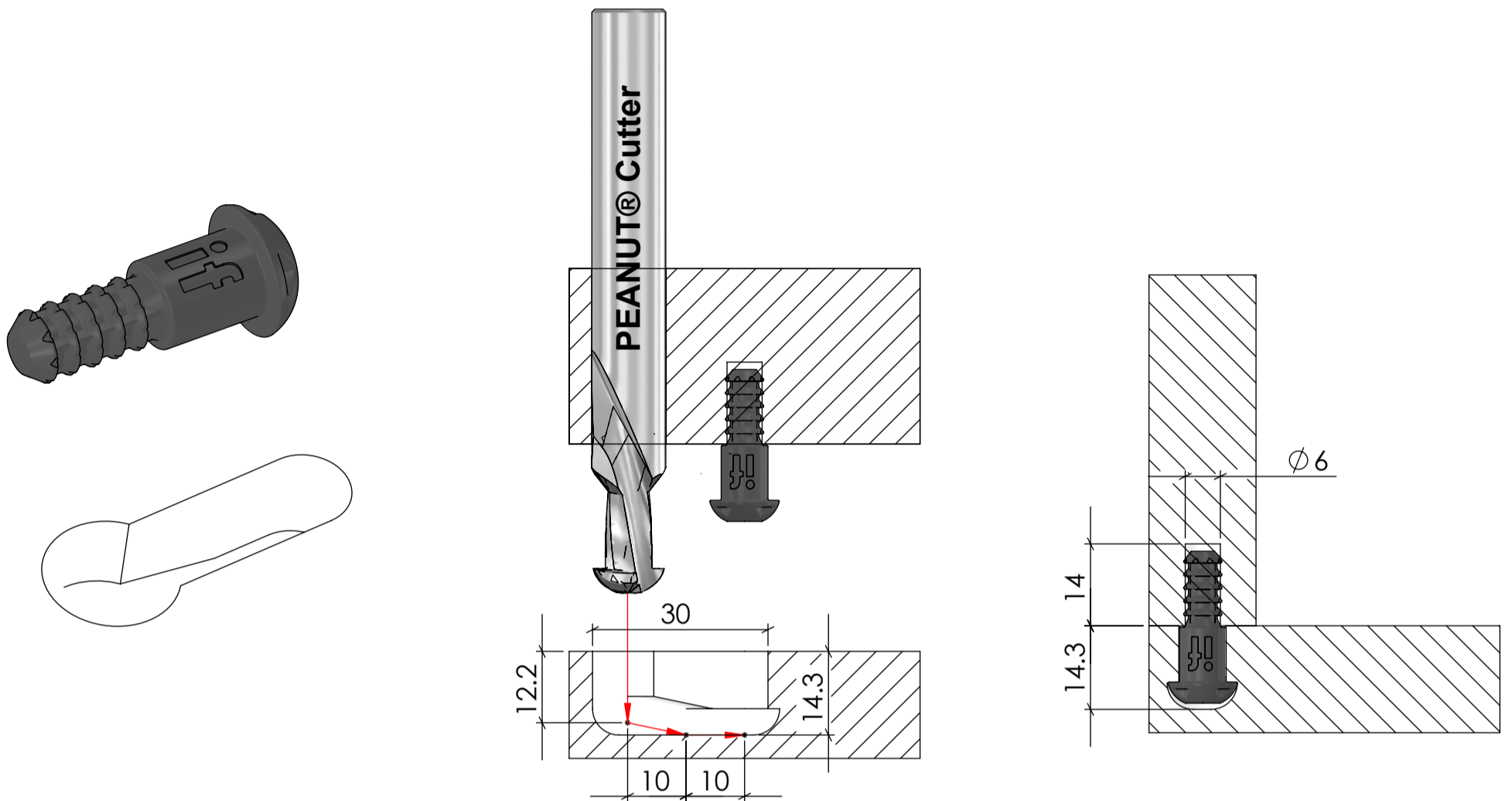

ENSAMBLAJE

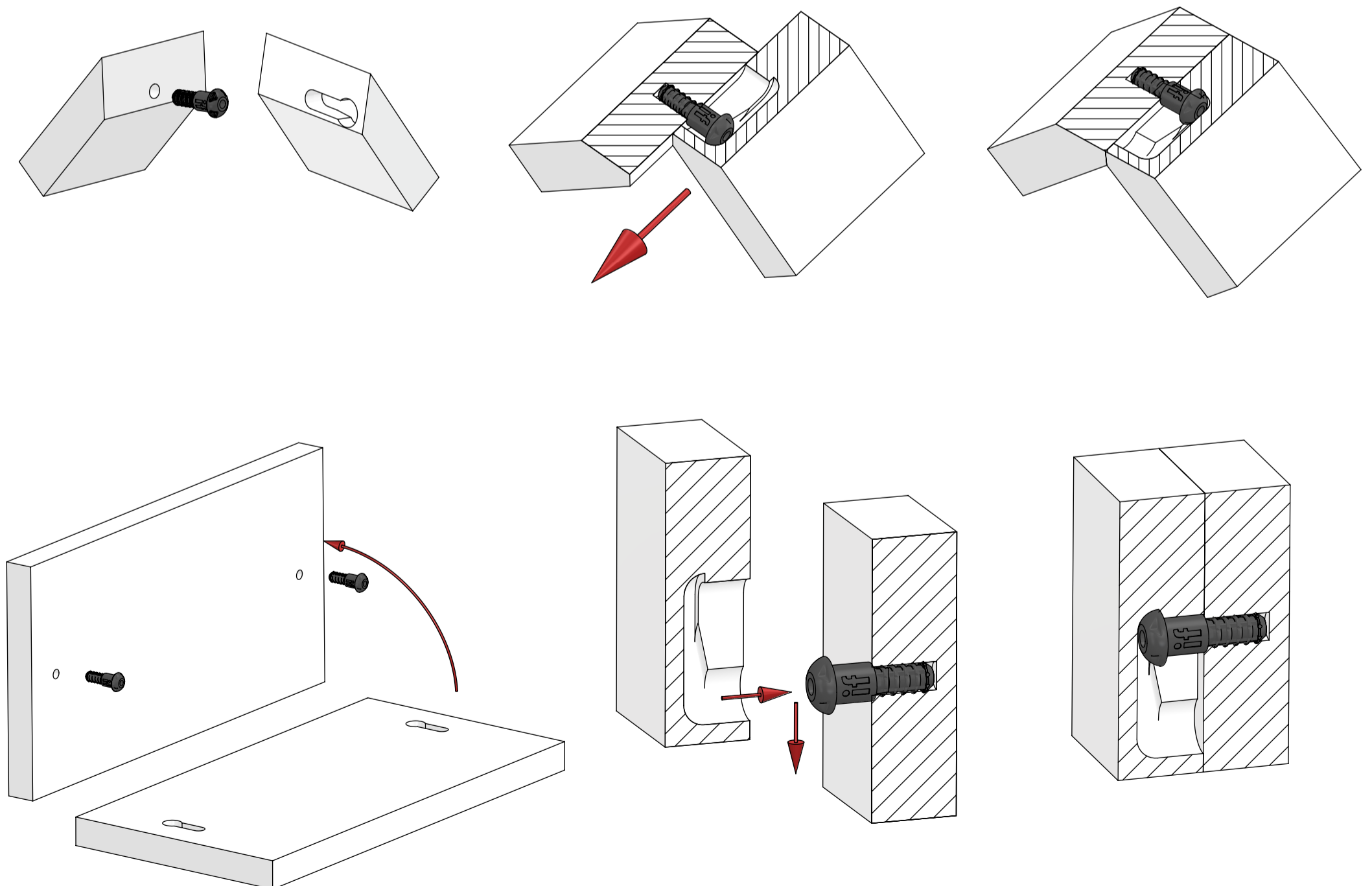

APLICACIONES

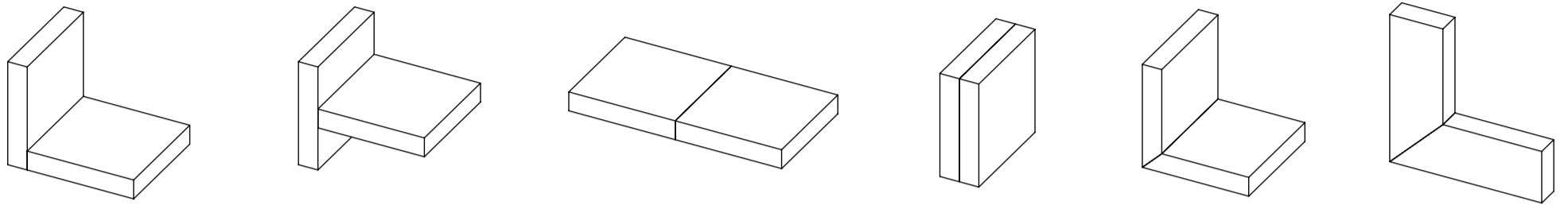

ESPECIFICACIONES TÉCNICAS

PEANUT® 3 Tecnical data

COMPONENT COMPOSITION	GLASS-FIBRE REINFORCED PLASTIC
MATERIAL THICKNESS	90° JOINT: >15.3mm 45° JOINT: >18mm
TOLERANCE (PEANUT CUTTER SLOT)	+0.3mm -0.4mm (DEPTH)

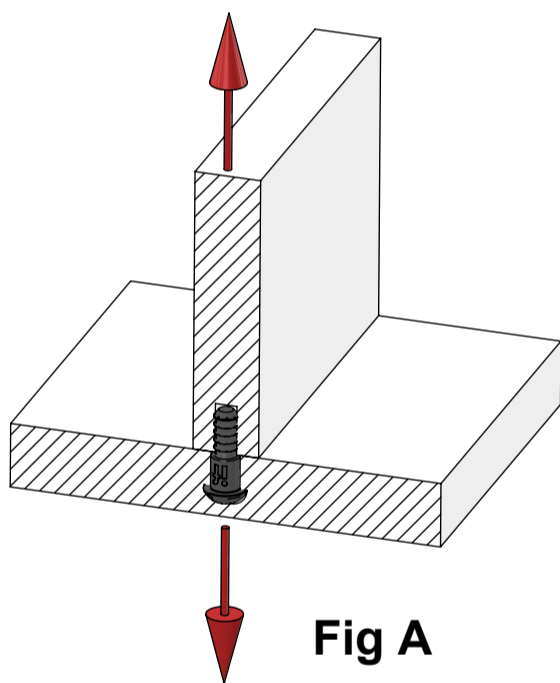

Fig A

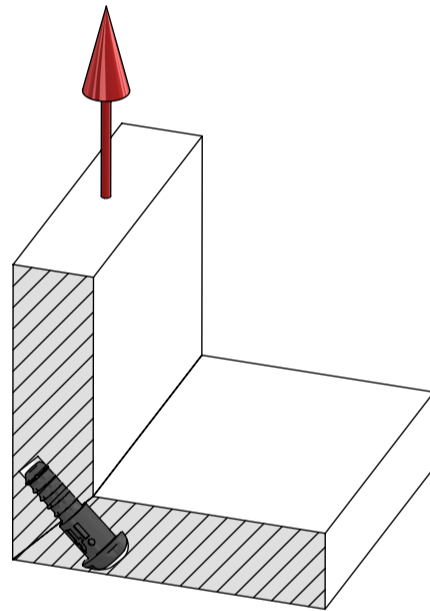
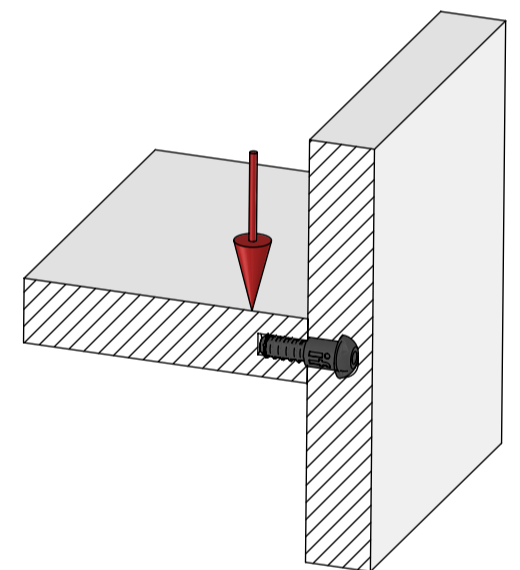

Fig B



Tested by: **CATAS**

Tested by: **if**

PEANUT® 3 Tensile/shear strength (based on one component)

MATERIAL	TENSILE 90° (Fig A)	TENSILE 45° (Fig B)	SHEAR STRENGTH (Fig C)
PARTICLE BOARD (18mm MFC)	930N / 93KG	600N / 60KG	670N / 67KG
MDF (18mm)	1090N / 109KG	670N / 67KG	930N / 93KG

PEANUT® 3 Tooling requirements

IF SOLID CARBIDE PEANUT CUTTER	MAX RPM 14000	CREATES 6500+ SLOTS (BASED ON MELAMINE FACED PARTICLE BOARD) THIS TOOL CANNOT BE SHARPENED
6mm SOLID CARBIDE DRILL		ANY 6mm DRILL WILL WORK (WE HAVE FOUND A SOLID CARBIDE DRILL GIVES BEST RESULTS)