

RILLE

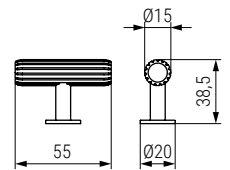

Código
Code

Acabado
Finish

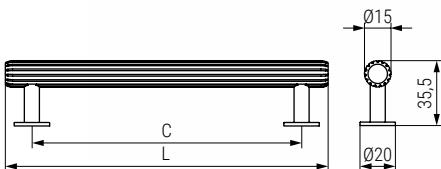

| | | |
|---------|--------------------------------|------|
| 991.921 | inox look/stainless steel look | 1/25 |
| 991.922 | latón cepillado/brushed brass | 1/25 |
| 991.923 | negro cepillado/brushed black | 1/25 |

| Código Code | C | L | Acabado Finish | |
|----------------|-----|-----|--------------------------------|------|
| 991.924 | 160 | 190 | inox look/stainless steel look | 1/25 |
| 991.925 | 160 | 190 | latón cepillado/brushed brass | 1/25 |
| 991.926 | 160 | 190 | negro cepillado/brushed black | 1/25 |
| 991.927 | 320 | 350 | inox look/stainless steel look | 1/25 |
| 991.928 | 320 | 350 | latón cepillado/brushed brass | 1/25 |
| 991.929 | 320 | 350 | negro cepillado/brushed black | 1/25 |
| 991.930 | 480 | 510 | inox look/stainless steel look | 1/25 |
| 991.931 | 480 | 510 | latón cepillado/brushed brass | 1/25 |
| 991.932 | 480 | 510 | negro cepillado/brushed black | 1/25 |

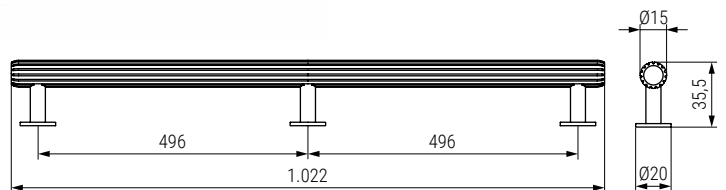

Código
Code

Acabado
Finish



| | | |
|---------|--------------------------------|------|
| 991.933 | inox look/stainless steel look | 1/15 |
| 991.934 | latón cepillado/brushed brass | 1/15 |
| 991.935 | negro cepillado/brushed black | 1/15 |

